

Xrefs: S:\ENGINEERING\Traffic\STAFF FOLDERS\Chef\Draft Revised Standards_Master.dwg Plot Date: Nov 12, 2020 at 08:11
 Path: S:\ENGINEERING\Traffic\STAFF FOLDERS\Chef\Draft Revised Standards_Master.dwg

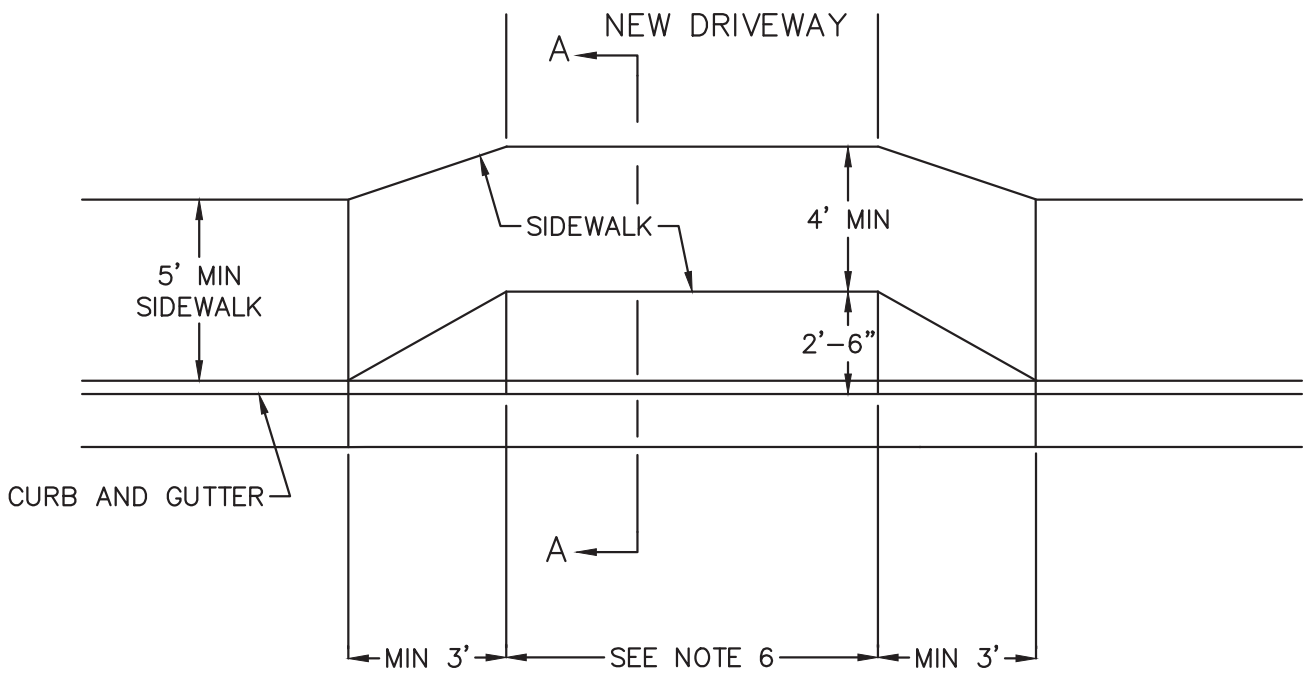

PLAN

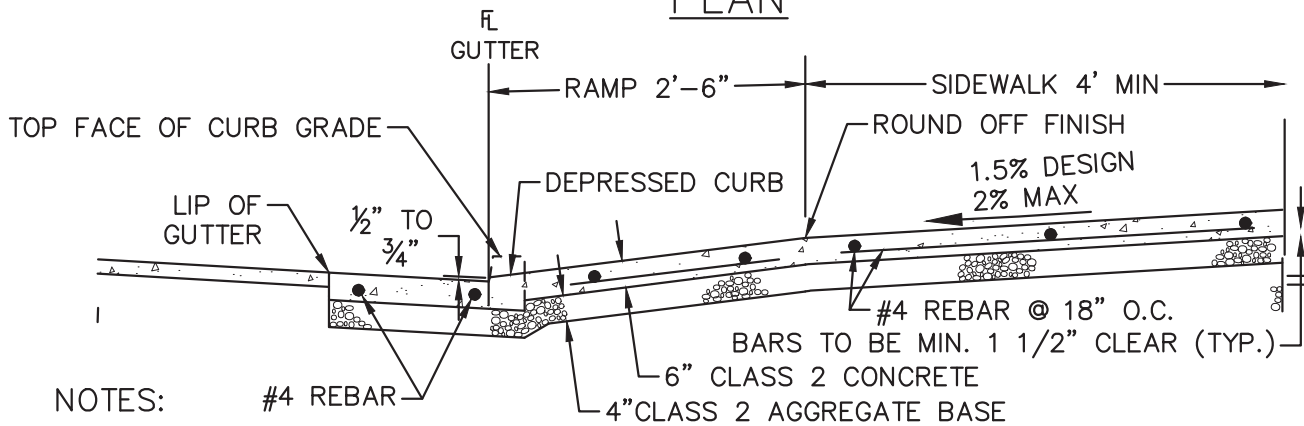

SECTION A-A

NOTES:

1. REBAR TO BE PLACED IN THAT PORTION OF DRIVEWAYS LOCATED WITHIN THE RIGHT OF WAY.
2. BASE MATERIAL SHALL BE COMPACTED TO A RELATIVE COMPACTION OF 95%.
3. CONSTRUCT A WEAKENED PLANE JOINT AT THE CENTER OF THE DRIVEWAY (1/8" WIDE BY 1" DEEP). CONSTRUCT SCORE MARKS AT A MAXIMUM SPACING OF 5 FEET.
4. AS AN ALTERNATE ON COMMERCIAL DRIVEWAYS, THE SIDEWALK GRADE THROUGH THE DRIVEWAY MAY BE DEPRESSED 2". THE SIDEWALK GRADE TRANSITIONS SHALL BE ACCOMPLISHED IN THE 4-FOOT OFFSET SECTION.
5. CONCRETE CONTAINING SIX SACKS OF CEMENT PER CUBIC YARD MEETS THE CRITERION FOR CLASS 2 CONCRETE.
6. FOR SINGLE FAMILY DWELLING MIN DRIVEWAY WIDTH SHALL BE 12'. FOR COMMERCIAL USES, MIN DRIVEWAY WIDTH SHALL BE EITHER 18' OR 24' AS DIRECTED BY DTPW.

| | | |
|--|--------------------|--------------------|
| COUNTY OF SONOMA DEPARTMENT OF TRANSPORTATION AND PUBLIC WORKS | | |
| URBAN DRIVEWAY LIGHT USE COMMERCIAL AND RESIDENTIAL | | |
| DATE: MAY 2004 | REVISED: JUNE 2020 | |
| APPROVED BY: JH | SCALE: NONE | DRAWING NO. 808 |