

Xrefs: S:\ENGINEERING\Traffic\STAFF FOLDERS\Chet\Draft Revised Standards_Master.dwg Plot Date: Nov 12, 2020 at 08:10
 Path: S:\ENGINEERING\Traffic\STAFF FOLDERS\Chet\Draft Revised Standards_Master.dwg

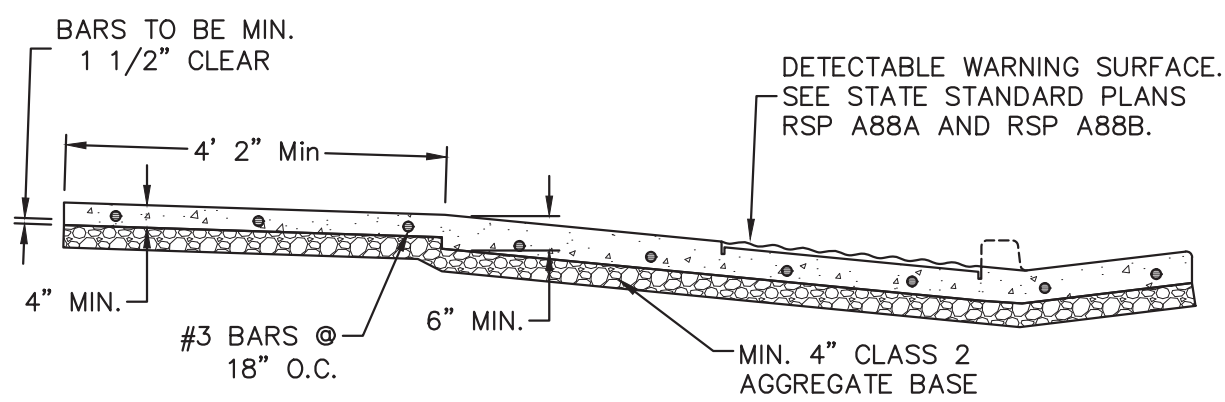
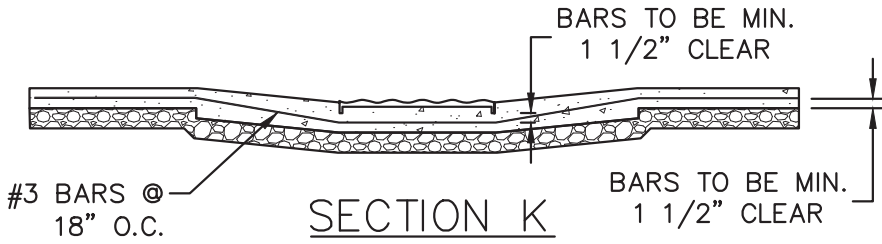
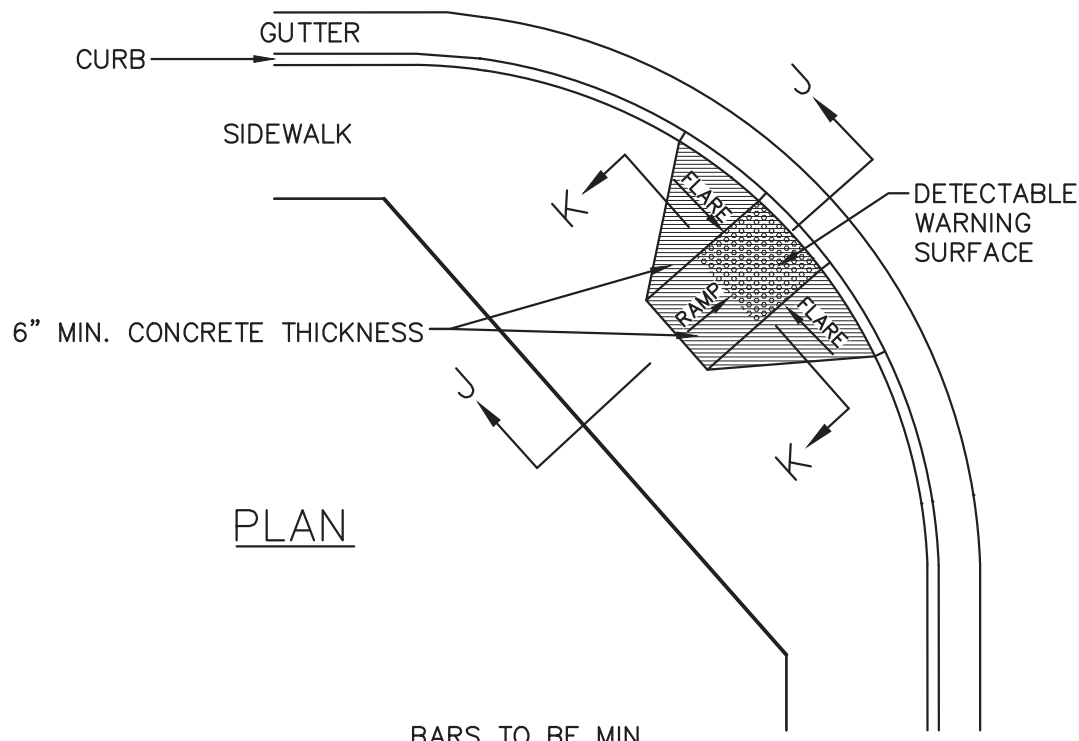

- NOTES:
1. THIS DRAWING REPRESENTS TYPICAL CONCRETE AND BEDDING CONSTRUCTION REQUIREMENTS FOR ALL TYPES OF CURB RAMPS.
 2. CONCRETE SHALL CONTAIN SIX SACKS OF CEMENT PER CUBIC YARD.
 3. SEE GENERAL NOTES ON SONOMA COUNTY DEPARTMENT OF TRANSPORTATION AND PUBLIC WORKS CONSTRUCTION STANDARDS DRAWING 224B.
 4. BASE MATERIAL SHALL BE COMPACTED TO A MINIMUM RELATIVE COMPACTION OF 95%.

COUNTY OF SONOMA DEPARTMENT OF TRANSPORTATION AND PUBLIC WORKS		
CURB RAMP EXCEPTIONS AND SUPPLEMENTAL REQUIREMENTS TO STATE STANDARD PLANS A88A AND A88B		
DATE: MAY 2004	REVISED: MAY 2018	
APPROVED BY: JH	SCALE: NONE	DRAWING NO. 224A